

- Proposed Extension (including New Plant Room) – Flr Area 114 sq.m.
- Alterations to Existing Building Layout to provide the Resource Room and internal corridor connections
- Upgrades of Existing Electrical Systems
- Upgrades of Existing Mechanical Systems
- Relocation and Upgrade of Waste Water Treatment System
- Temporary Decanting of 2 classrooms for Construction Period

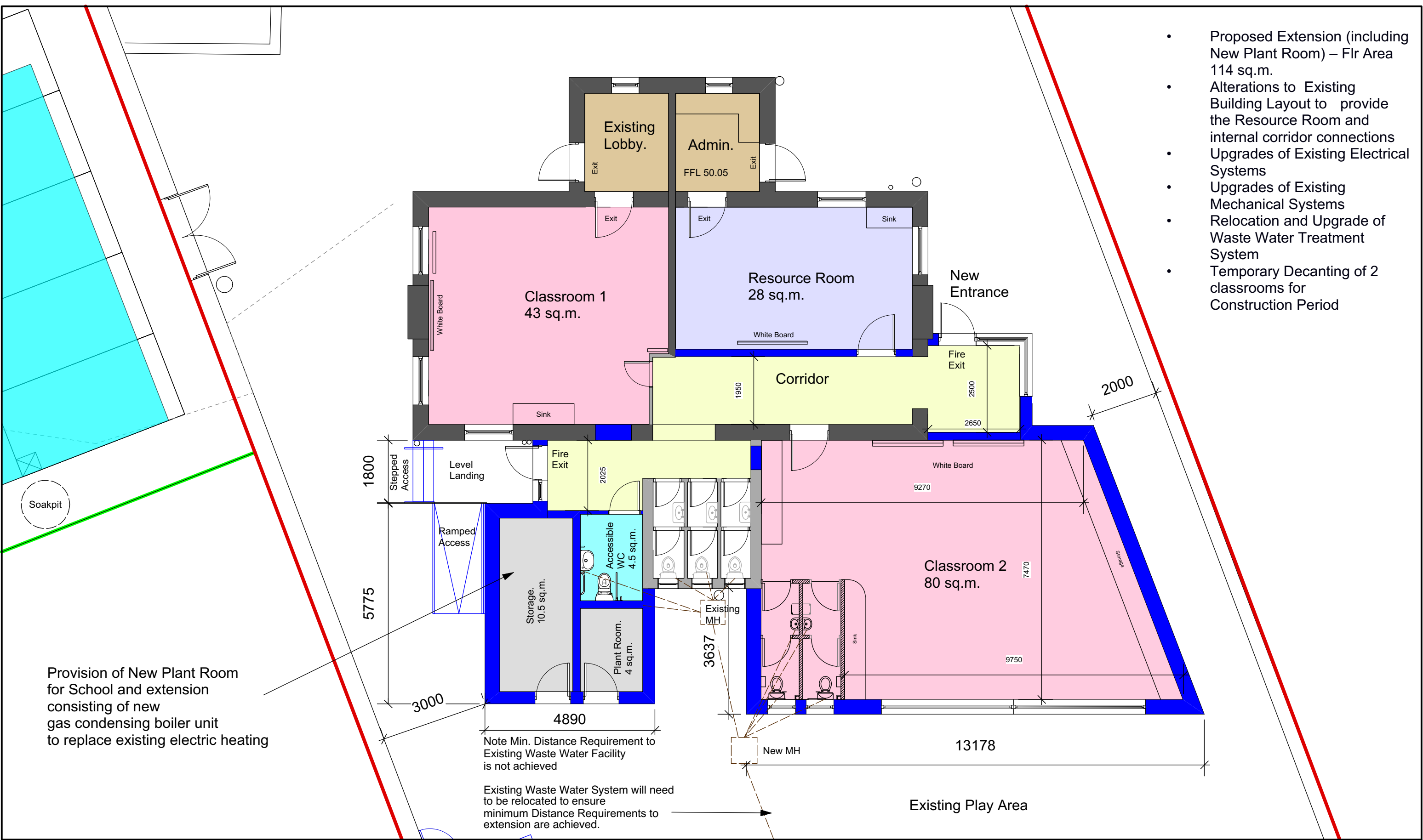

Provision of New Plant Room for School and extension consisting of new gas condensing boiler unit to replace existing electric heating

Note Min. Distance Requirement to Existing Waste Water Facility is not achieved

Existing Waste Water System will need to be relocated to ensure minimum Distance Requirements to extension are achieved.

Ground Floor Plan showing Proposed Extension Scale 1:100 at A3

Proposed Extension / Alterations Shown in Blue Area of Proposed Extension 114 sq.m.

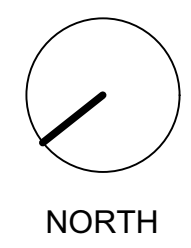

**MRG**  
consulting engineers

No.4 Day Place, Tralee, County Kerry.  
T (066)7123130 Fax (066)7123364 E-Mail :info@mrg.ie  
also : Northpoint Business Park, Mallow Road, Cork.

MRG Consulting Engineers Limited Civil Structural Architectural Environmental

Project		
Classroom Extension at Scoil Naomh Gobnait, Dún Chaoin, Co, Chiarraí		
Drawing		
Ground Floor Layout showing Proposed Extension		
Drawn: MOC	Project No. 121013	Drawing No. SK-202
Date: MAY 2022	Scale: 1:100 @ A3	Checked By: MW